

NOTE: THE OVERLOAD CAPACITIES FOR BENDING MOMENT, AXIAL AND RADIAL FORCE EXCEED 300% OF THOSE USED FOR CROSSTALK MEASUREMENT

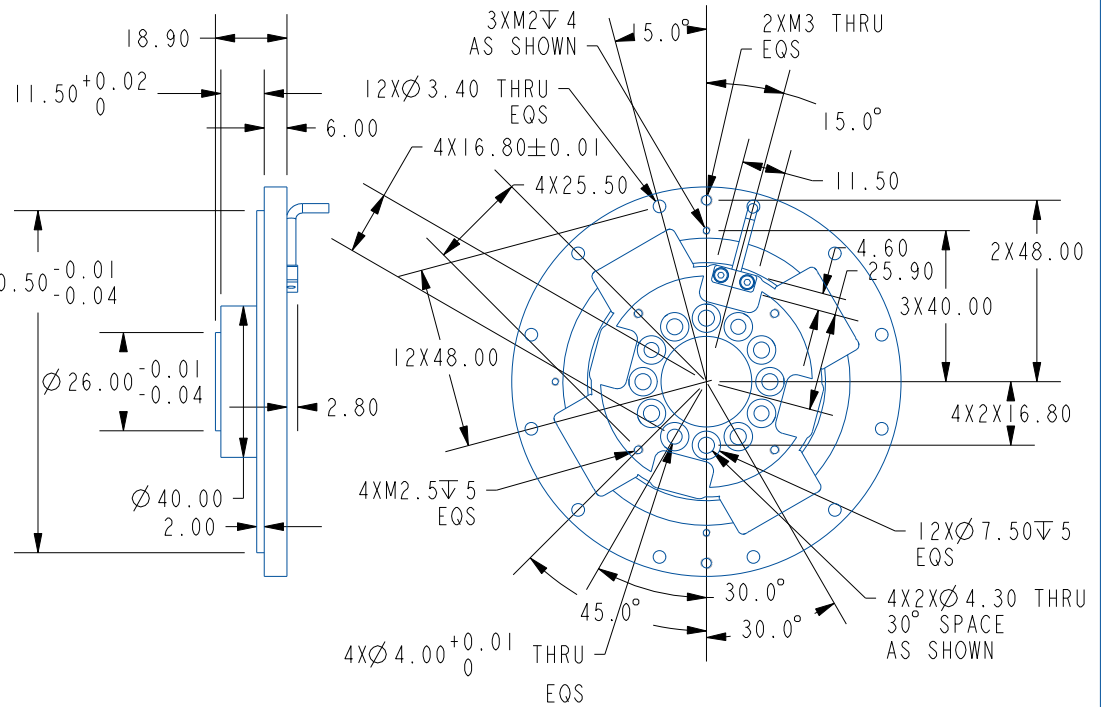

DRAWING IN THIRD ANGLE PROJECTION

ATTENTION: RED WIRE MUST BE CONNECTED TO POSITIVE SUPPLY VOLTAGE AND BLACK TO GROUND. OTHERWISE CIRCUIT MAY GET DAMAGED!

* WHEN PWR SUPPLY IS 4.5V, OUTPUT WILL BE 2.25±1.75V

WIRING CODE

COLOR	FUNCTION
RED	+EX
GREEN	+SIG
BLACK	GND
BROWN	-SIG

SPECIFICATIONS

CAPACITY (Nm)	330
OVERLOAD CAPACITY (%F.S.)	250
OUTPUT @ F.S. (V) NOMINAL	2.5±2 *
POWER SUPPLY (V)	4.5 TO 5V
BRIDGE RESISTANCE (Ω) NOMINAL	350
NON-LINEARITY (%F.S.)	0.5
HYSTERESIS (%F.S.)	1.0
OPERATING TEMP. RANGE (°C)	-20 TO +100
CROSSTALK (%F.S.)	1.0
AXIAL FORCE FOR CROSSTALK (N)	600
RADIAL FORCE FOR CROSSTALK (N)	1000
BENDING MOMENT FOR CROSSTALK (Nm)	110
TORSION ANGLE (CALCULATED)	0.04°
TORSIONAL STIFFNESS (KNm/RAD)	286
BENDING STIFFNESS (KNm/RAD)	35 **
MASS (KG)	0.14

SUNRISE INSTRUMENTS

www.srisensor.com

SINGLE AXIS TORQUE LOADCELL
D103MM, 330 Nm

UNLESS OTHERWISE SPECIFIED
DIMENSIONS ARE IN MM

M2210T

REV.
0.6